

Connections for the HDMI-ST

PCB Number 2633 Iss 2

The High Definition Multimedia Interface [HDMI] supplies both high-definition video and multi channel digital audio. It is an ALL DIGITAL interface with NO Analogue signals. HDMI is backward compatible with the DVI interface, but without the more advanced upgrades and no audio.

HDMI Cables

There is no industry standard for HDMI cables so different manufactures use different coloured cores in their cables. Also the manufactures change the colours of the cores inside their cables, so even through you may buy cables from the same place, no two cables are always the same.

Over the page the tables give typical pin-outs and shows examples, and is for reference only, you should verify this for the cable you are using.

We recommend you pin-out your cable using a multi-meter and the HDMI cable plugged into the HDMI-ST Adapter to find out which cable core goes to which connection.

Even though we supply HDMI cables, we cannot give the pin-out for these cables supplied, for the reasons stated above.

To find out the pin-out of your HDMI cable, please contact the cable manufacture.

Using the adapter

When terminating cables onto the connector they should ALL be cut to the same length, DON'T shorten some for neatness.

The cable consists of a number of individual screen pairs normally contained with different coloured foil. The foil should be trimmed back, the drain wire should be sleeved in green (insulation stripped from 7/0.2 equipment wire is ideal) and then the end of the foil sleeved to stop the foil unravelling further. Keep these pairs twisted to the same extent as they are in the cable, don't be tempted to twist tighter. Try and maintain the twist as near as possible to the screw terminals.

Panel Cutout

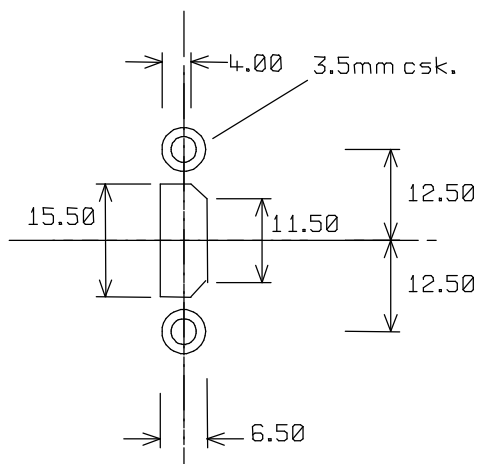

It is the same panel cutout for all Ikon HDMI adapters.

When using the HDMI-90BB the cable is to the left as viewed

HDMI Version 1.0 to 1.3C							
HDMI Pin No.	HDMI Signal	Example 1		Example 2		Example 3	
1	TMDS Data 2+	Blue	Silver Foil	Blue	Silver Foil	Red	Gold Foil #1
2	TMDS Data 2 Shield	Drain		Drain		Drain	
3	TMDS Data 2-	White		White		White	
4	TMDS Data 1+	Blue	Blue Foil	Blue	Blue Foil	Blue	Gold Foil #2
5	TMDS Data 1 Shield	Drain		Drain		Drain	
6	TMDS Data 1-	White		White		White	
7	TMDS Data 0+	Blue	Green Foil	Blue	Green Foil	Green	Gold Foil #3
8	TMDS Data 0 Shield	Drain		Drain		Drain	
9	TMDS Data 0-	White		White		White	
10	TMDS Clock+	Blue	Yellow Foil	Blue	Yellow Foil	Brown	Gold Foil #4
11	TMDS Clock Shield	Drain		Drain		Drain	
12	TMDS Clock-	White		White		White	
13	CEC	Green		Green		Grey	
14	Not Used	-		-		Violet	
15	DDC Clock	Gold		Orange	or Pale Orange	Orange	
16	DDC Data	Violet		Violet		Yellow	
17	Ground	Pink		White		Pink	
18	+5V Power	Red		Red	or Orange	Red	
19	Hot Plug Detect	Yellow		Yellow		White	
20	SHELL	Screen		Screen		Screen	

HDMI Version 1.4+ with Ethernet					
HDMI Pin No.	HDMI Signal	Example 1		Example 2	
1	TMDS Data 2+	Red	Gold Foil #1	Brown	Silver Foil #1
2	TMDS Data 2 Shield	Drain		Drain	
3	TMDS Data 2-	White		White	
4	TMDS Data 1+	Blue	Gold Foil #2	Blue	Silver Foil #2
5	TMDS Data 1 Shield	Drain		Drain	
6	TMDS Data 1-	White		White	
7	TMDS Data 0+	Green	Gold Foil #3	Green	Silver Foil #3
8	TMDS Data 0 Shield	Drain		Drain	
9	TMDS Data 0-	White		White	
10	TMDS Clock+	Brown	Gold Foil #4	Red	Silver Foil #4
11	TMDS Clock Shield	Drain		Drain	
12	TMDS Clock-	White		White	
13	CEC	Grey		Green	
14	HEC-Ethernet Data-	Violet		Orange	Silver Foil #5
15	DDC Clock	Orange		White	
16	DDC Data	Yellow		Grey	
17	DDC/CEC/HEC-Ethernet Ground	Pink		Drain	Silver Foil #5
18	+5V Power	Red		Red	
19	Hot Plug Detect / HEC-Ethernet Data+	White		White	Silver Foil #5
20	SHELL	Screen		Screen	

Please note:

Different manufactures of HDMI cables use different colours in their cables from those mentioned above. The info above is for reference only and only shows examples of typical cable connections. We recommend you pin out your cable using a multi-meter, the HDMI cable & the HDMI-ST adapter